

# GEMÜ C12A

Electrical position indicator

EN

## Assembly instructions

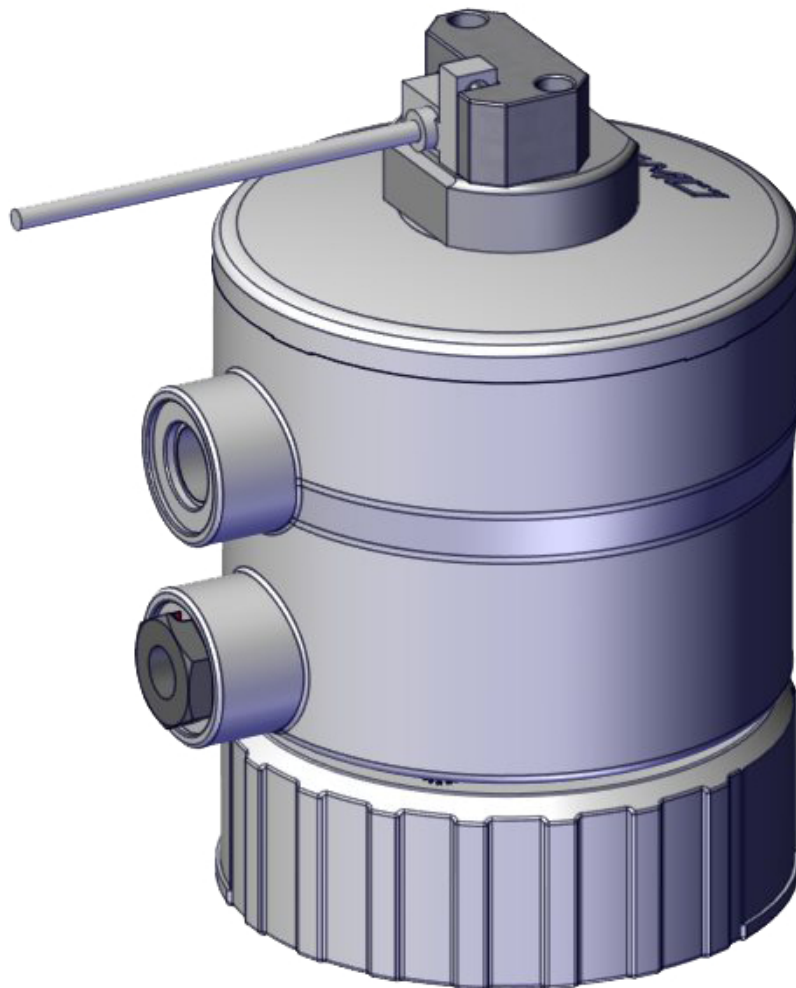

## 1 Assembly and installation

### 1.1 Actuator size 1

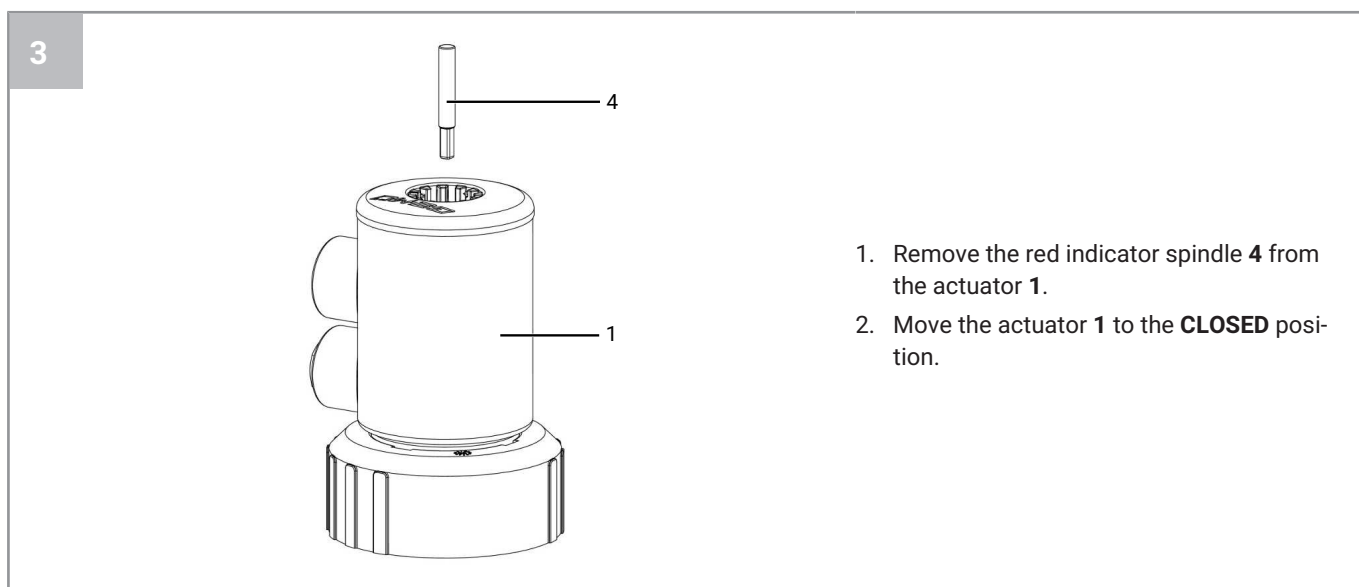
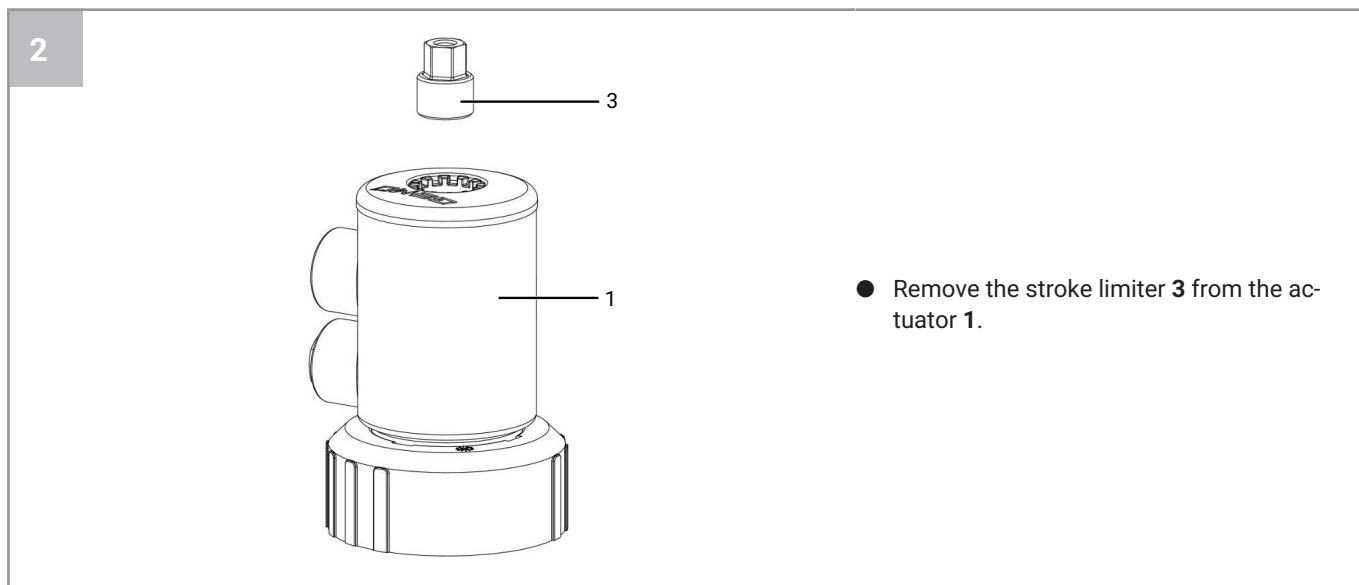
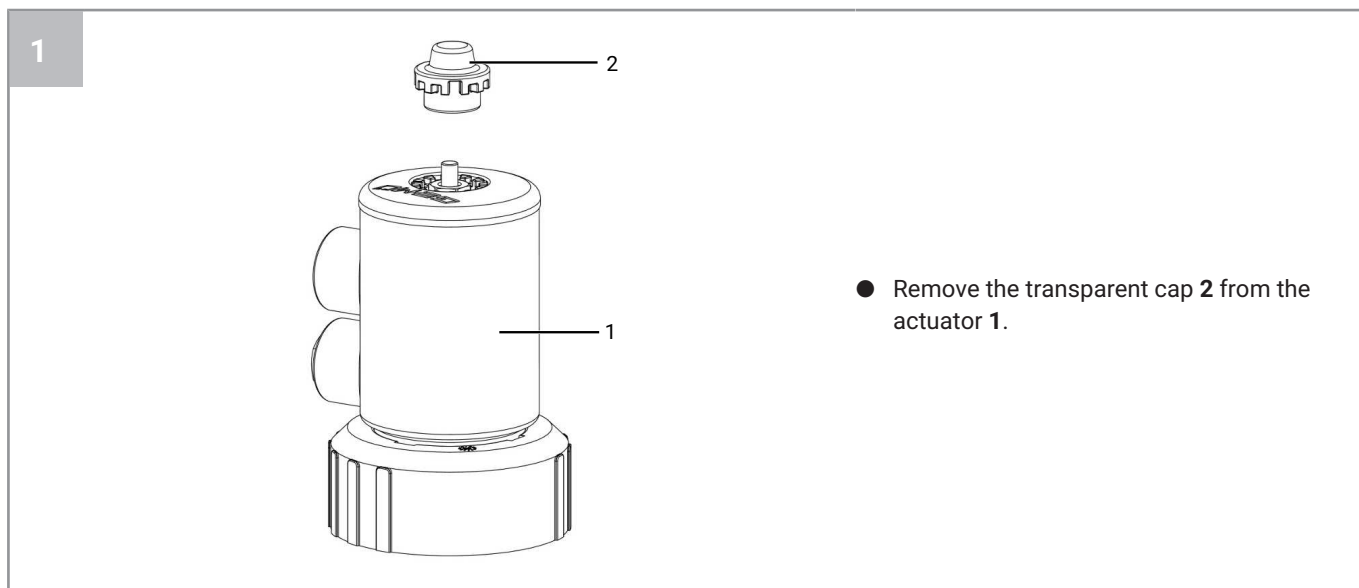

4

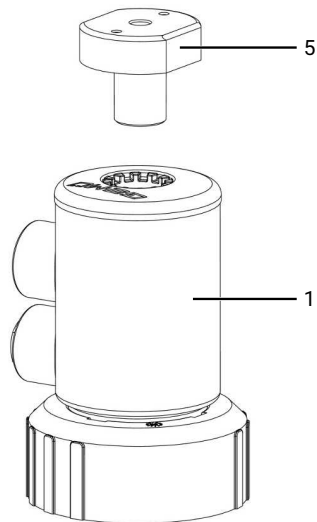

- Screw the adapter **5** into the actuator **1**.

**Note:** Use an appropriate tool for tightening.

Torque: 1–3 Nm.

Align spanner flat such that it is parallel to the control air connectors.

5

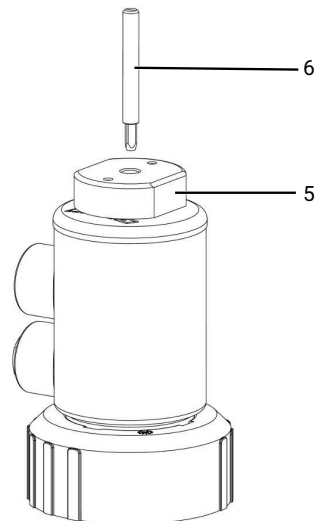

- Knock the new indicator spindle **6** down through the adapter **5** as far as it will go (see arrow) into the actuator piston.

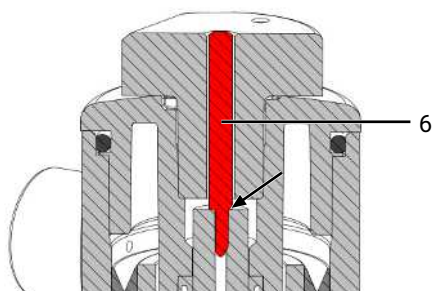

6

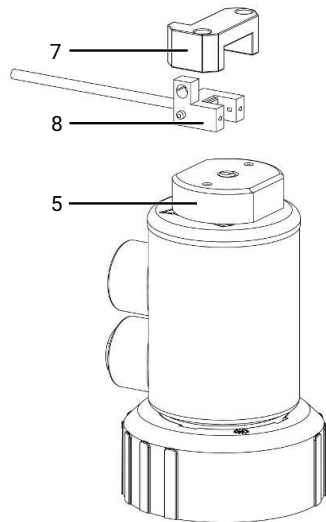

- Place the sensor **8** and the fixing piece **7** on the adapter **5**.

7

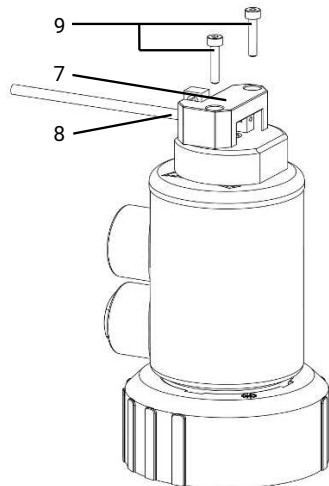

- Tighten the sensor **8** and fixing piece **7** with bolts **9** (0.2 Nm).

8

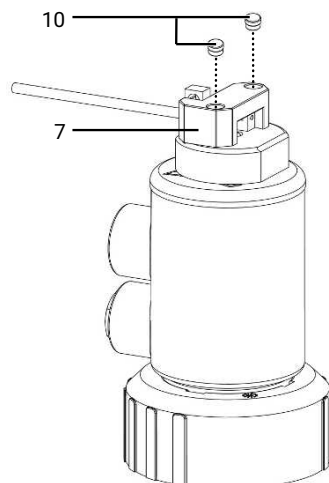

1. Fit protective caps **10** into fixing piece **7**.
2. Connect the electrical position indicator in accordance with the connection diagram. (see "Electrical connection", page 12)

**1.2 Actuator size 2**

1

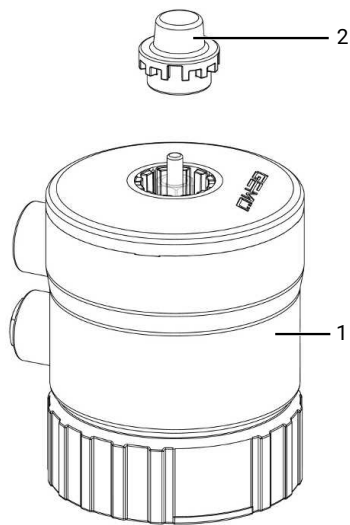

- Remove the transparent cap **2** from the actuator **1**.

2

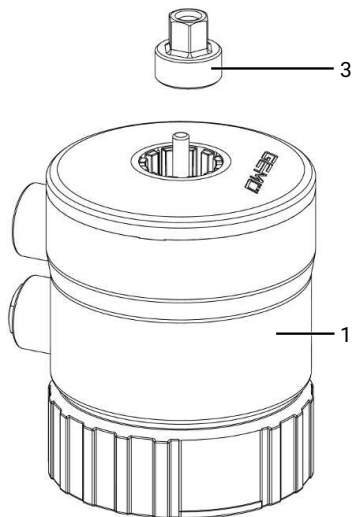

- Remove the stroke limiter **3** from the actuator **1**.

3

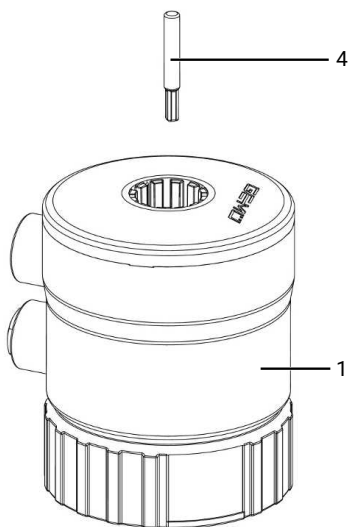

1. Remove the red indicator spindle **4** from the actuator **1**.
2. Move the actuator **1** to the **CLOSED** position.

4

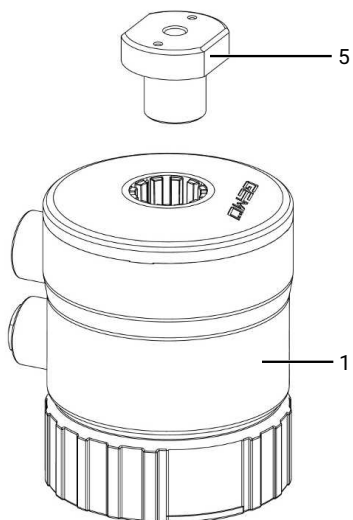

- Screw the adapter 5 into the actuator 1.  
**Note:** Use an appropriate tool for tightening.  
 Torque: 1–3 Nm.  
 Align spanner flat such that it is parallel to the control air connectors.

5

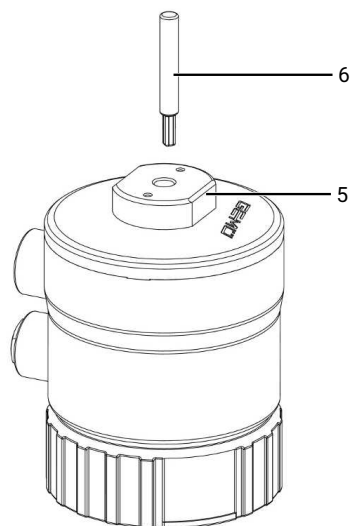

- Knock the new indicator spindle 6 down into the adapter 5 so that it is flush.

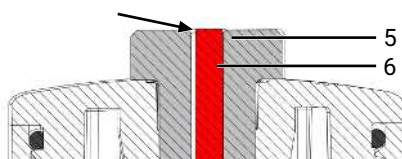

6

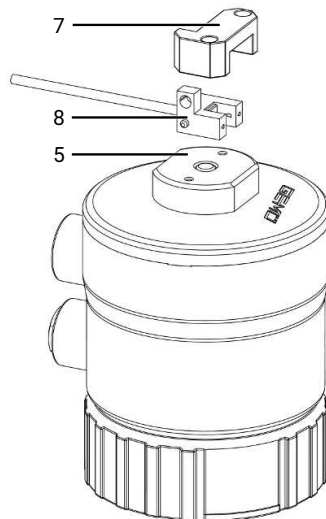

- Place the sensor **8** and the fixing piece **7** on the adapter **5**.

7

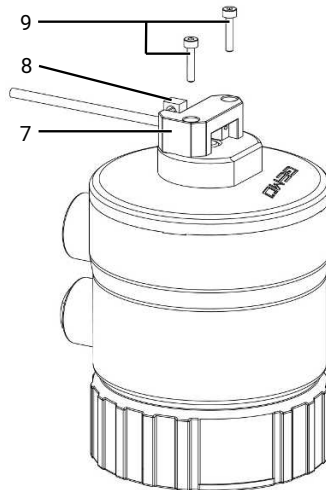

1. Tighten the sensor **8** and fixing piece **7** with bolts **9** (0.2 Nm).
2. Move the actuator into the **OPEN** position.
3. Indicator spindle **6** is pressed against the stop on the fixing piece **7** and adjusts itself.

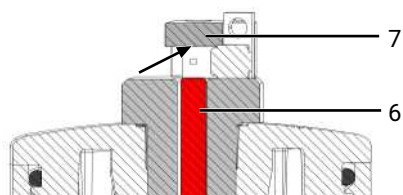

8

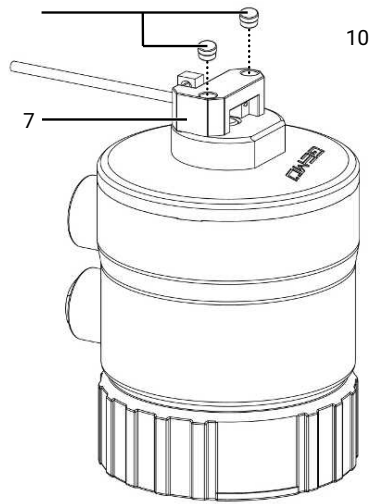

1. Fit protective caps **10** into fixing piece **7**.
2. Make the electrical connection (see "Electrical connection", page 12).

### 1.3 Actuator size 3

1

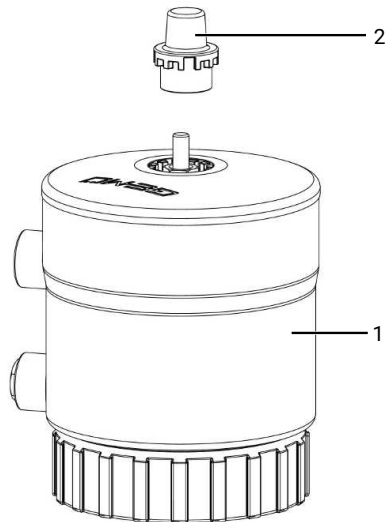

- Remove the transparent cap **2** from the actuator **1**.

2

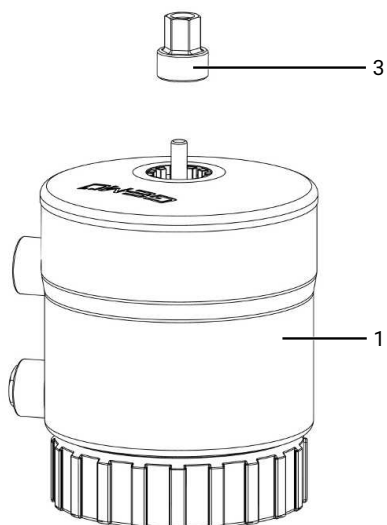

- Remove the stroke limiter **3** from the actuator **1**.



3

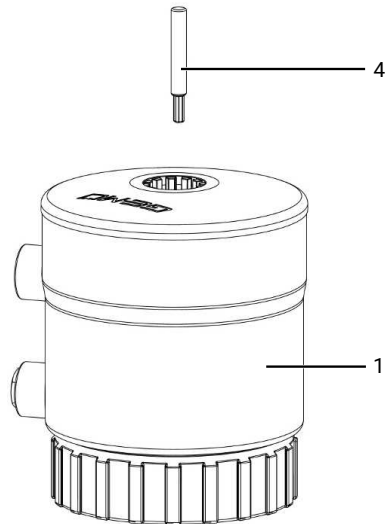

1. Remove the red indicator spindle **4** from the actuator **1**.
2. Move the actuator **1** to the **CLOSED** position.

4

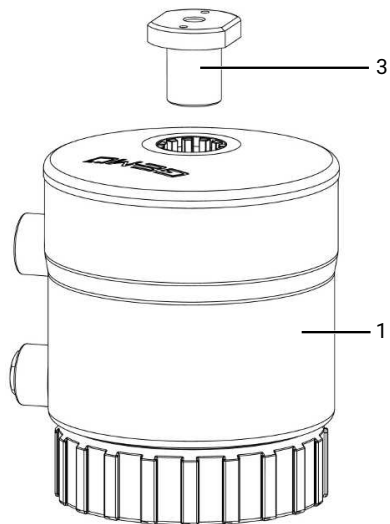

- Screw the adapter **5** into the actuator **1**.  
**Note:** Use an appropriate tool for tightening.  
Torque: 1–3 Nm.  
Align spanner flat such that it is parallel to the control air connectors.

5

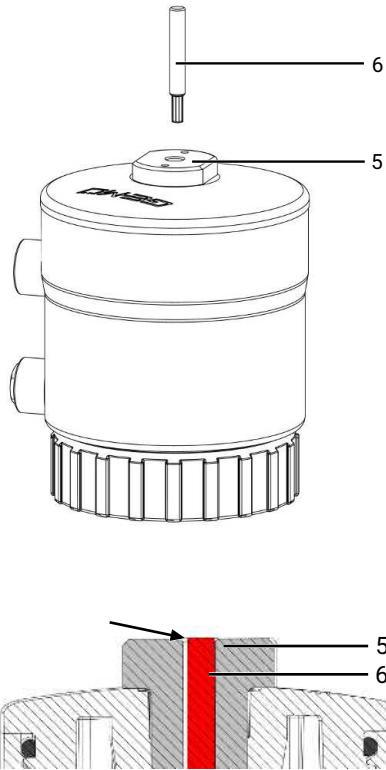

- Knock the new indicator spindle **6** down into the adapter **5** so that it is flush.

6

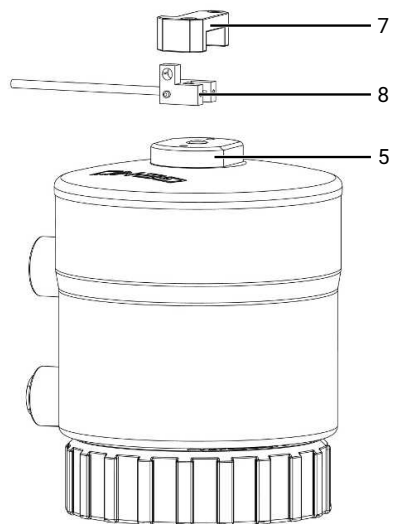

- Place the sensor **8** and the fixing piece **7** on the adapter **5**.

7

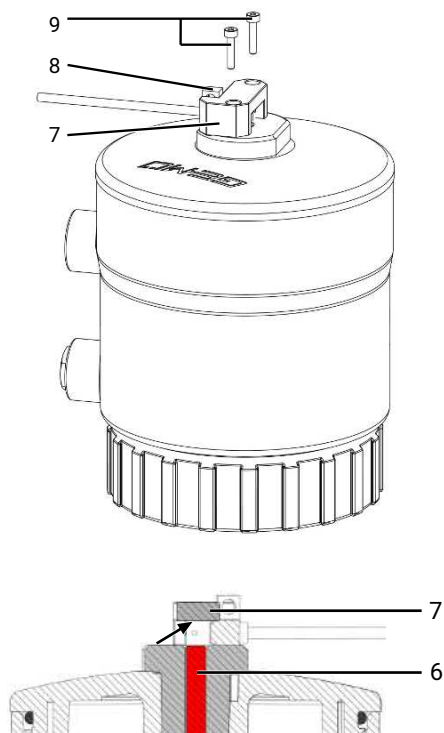

1. Tighten the sensor **8** and fixing piece **7** with bolts **9** (0.2 Nm).
2. Move the actuator into the **OPEN** position.
3. Indicator spindle **6** is pressed against the stop on the fixing piece **7** and adjusts itself.

8

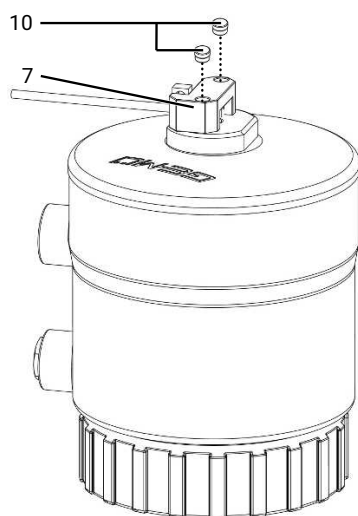

1. Fit protective caps **10** into fixing piece **7**.
2. Make the electrical connection (see "Electrical connection", page 12).

## 2 Electrical connection

<b>⚠ CAUTION</b>	
	<p><b>Risk of crushing!</b></p> <p>► Risk of crushing from reaching into the light barrier.</p>

### 2.1 PNP

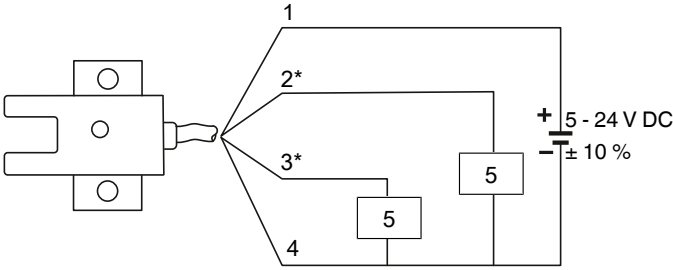

Number	Colour
1	Brown
2	Black*
3	White*
4	Blue
5	Load

\*Please isolate any unused cables

	Colour	Output
Output 1	Black	Light ON
Output 2	White	Dark ON

NPN version on request



GEMÜ Gebr. Müller Apparatebau GmbH & Co. KG  
Fritz-Müller-Straße 6-8, 74653 Ingelfingen-Criesbach, Germany  
Tel. +49 (0)7940 123-0 · info@gemue.de  
www.gemu-group.com

Subject to alteration

10.2023 | 88874107